

- ② PHD2 holdown with 4x stud. Make sure to align with holdown (or tie-down strap) above as occurs.
  - ⑦⑧ 7/8" threaded rod holdown anchor as specified for Hardy Panels.
- Notes:
1. May use double studs for PHD holdowns provided double studs are nailed/screwed together per sill requirements in Shear-Wall Schedule (SWS).
  2. For holdowns, refer to details 9/S1.1, 17/S1.1 and 20/S1.1.

Refer to sheet S2.0 for foundation locations and other information not shown or stated here.

- Post as specified elsewhere.
- HSS4x4x1/4 steel tube column.
- ===== 1st floor wall.

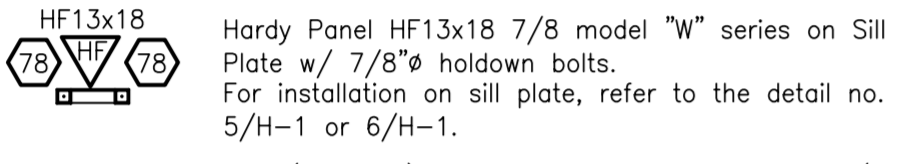
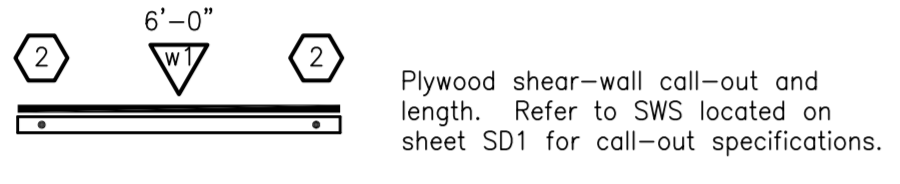

- H1. Hardy Frame (or Panel) by Simplified Structural Systems (ICC REPORT PFC-5342, 800-754-3030). Refer to details by manufacturer. Contractor to verify required Hardy Frame height in field before ordering. Contact SSE with any questions of fit. Posts and beams are not to be supported by Hardy Frames and Panels. Contractor to contact SSE if plans indicate otherwise.
- H2. For installation guides and other general notes for Hardy Frame/Panel, refer to the sheet H-3.
- H3. For Anchor embedment depth, refer to the detail no. 29A/H-3.
- H4. For double top plate connection, refer to the detail no. 26/H-1.

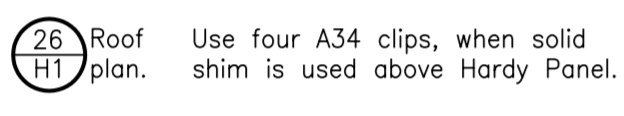

Not Used

19

Not Used

20

Shear-Wall Layout

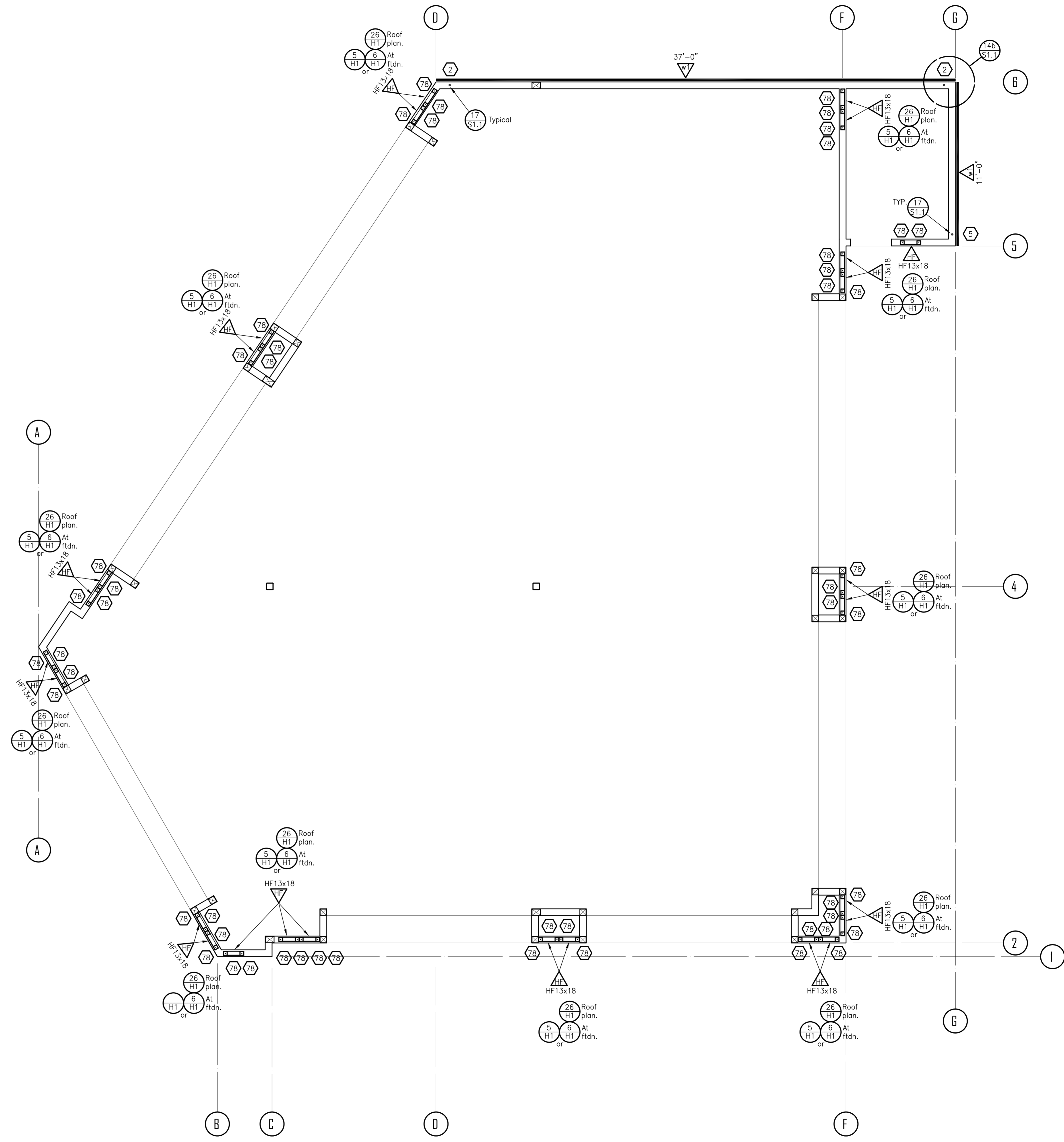

Practicing Engineering since 1983

All drawings electronic or printed are the sole property of SSE and are not to be reproduced without written consent from SSE



Not valid without wet signature.

**Bascom Retail  
 New Comercial Building**  
 Corner of Jewell Drive and Bascom Avenue, San Jose, CA

JE Architects  
 1155 Meridian Ave., Ste. 208  
 San Jose, CA 95125-4331  
 408-265-5255

April 6, 2005

Revisions	
No.	Description
1	06/15/05 Plan Check 01

Project Number: 1817-04 Drawn By: Sezen

Designed By: Sezen Checked By: Moon

Sheet Title:  
**Shear-Wall**

Sheet Number:  
**S3.0**